

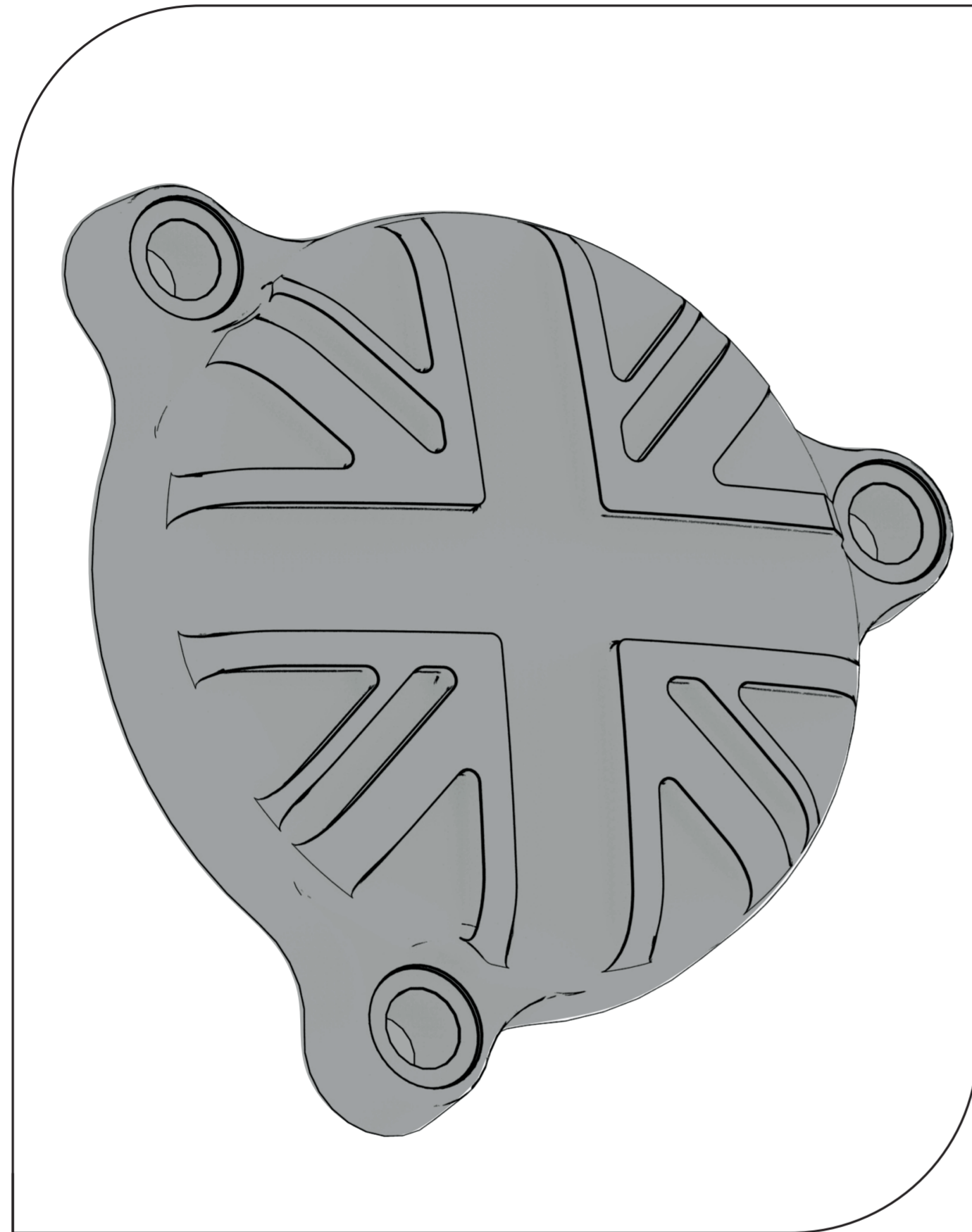

**OIL FILTER CARTER CAP
(ROYAL ENFIELD 350CC)**

Installation Manual

What's in the box



1x
OIL FILTER
CARTER CAP

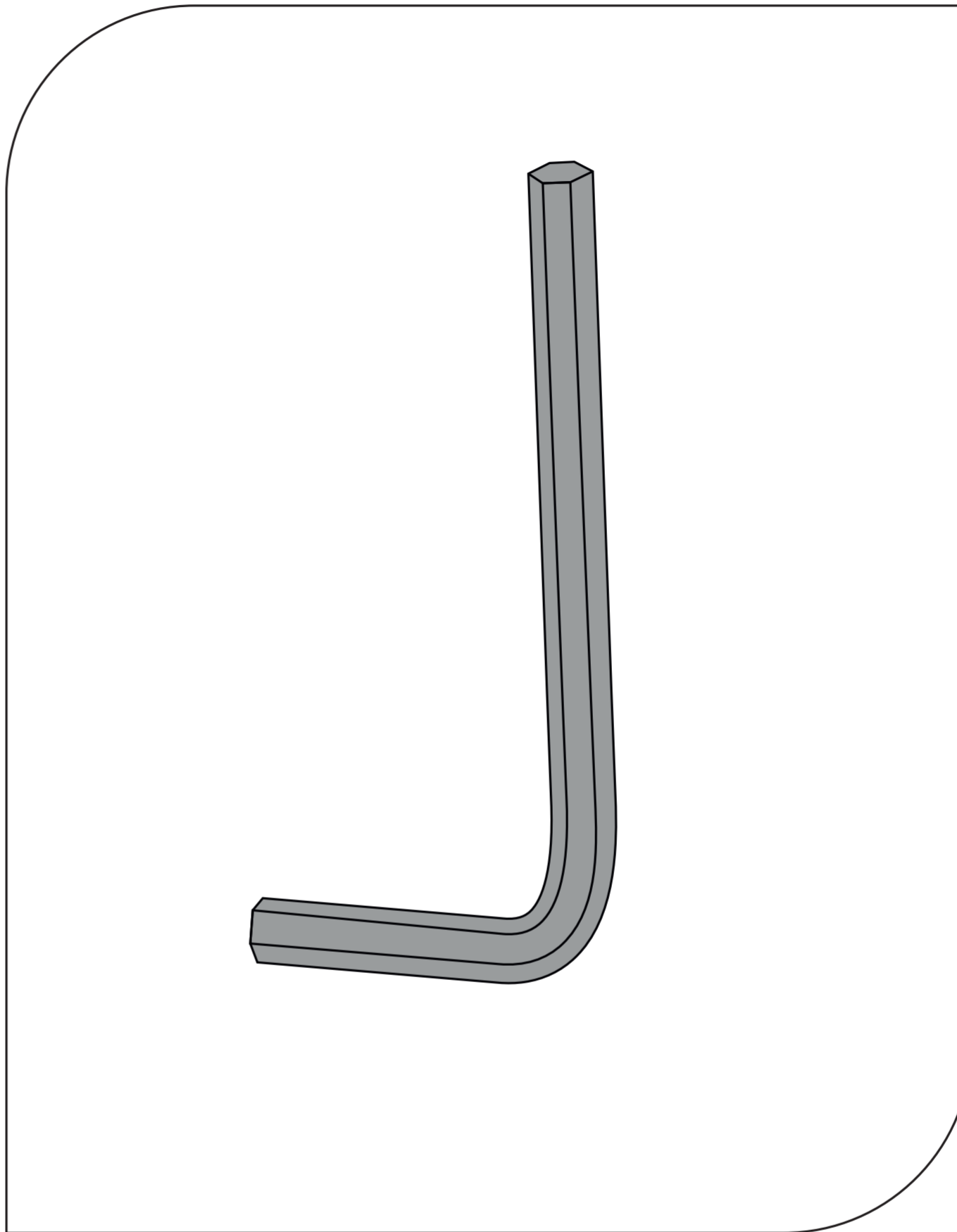

1x
N°5 ALLEN KEY



STEP . 1

Unscrew the original oil cap with the allen key to remove it.

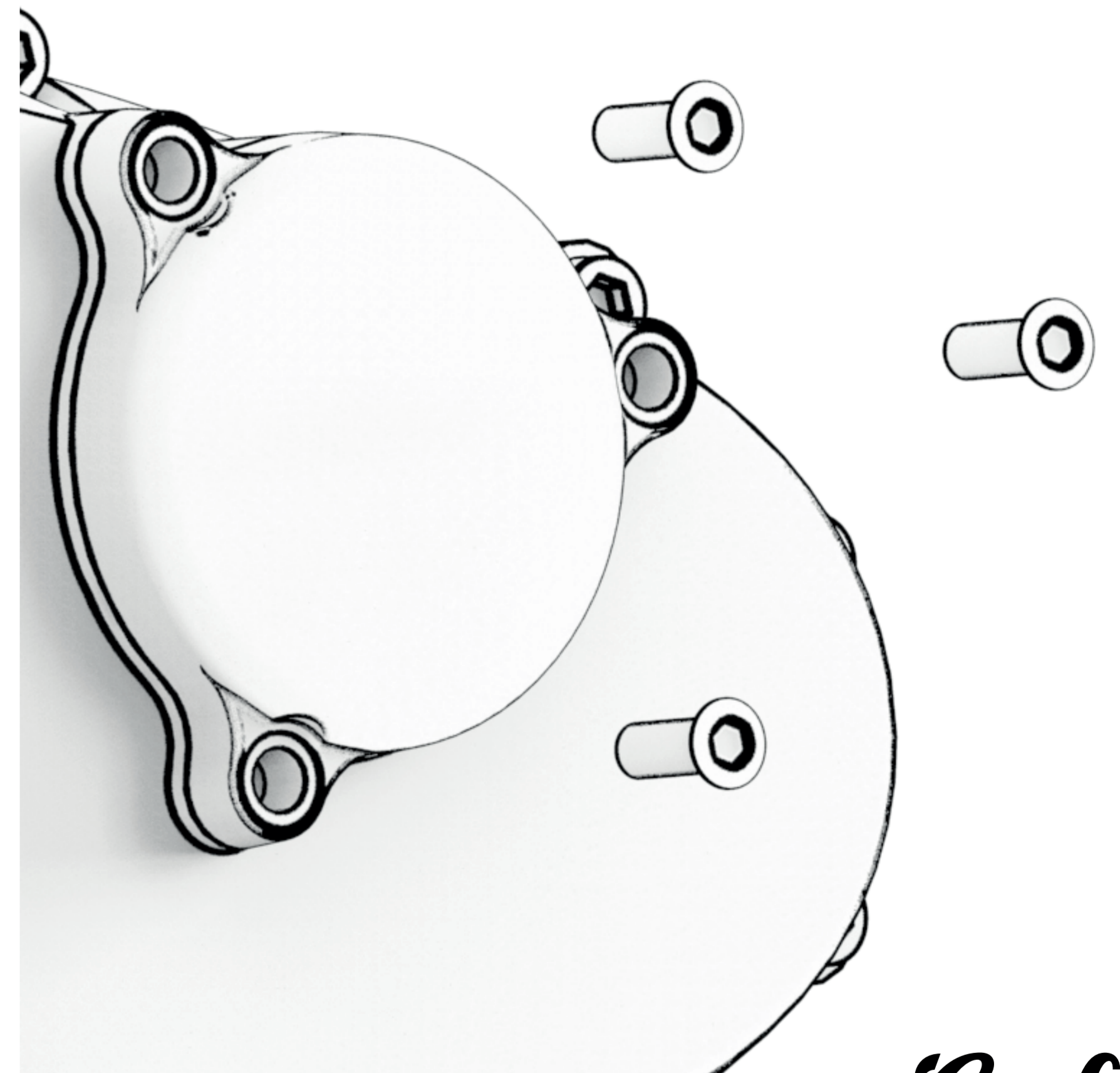
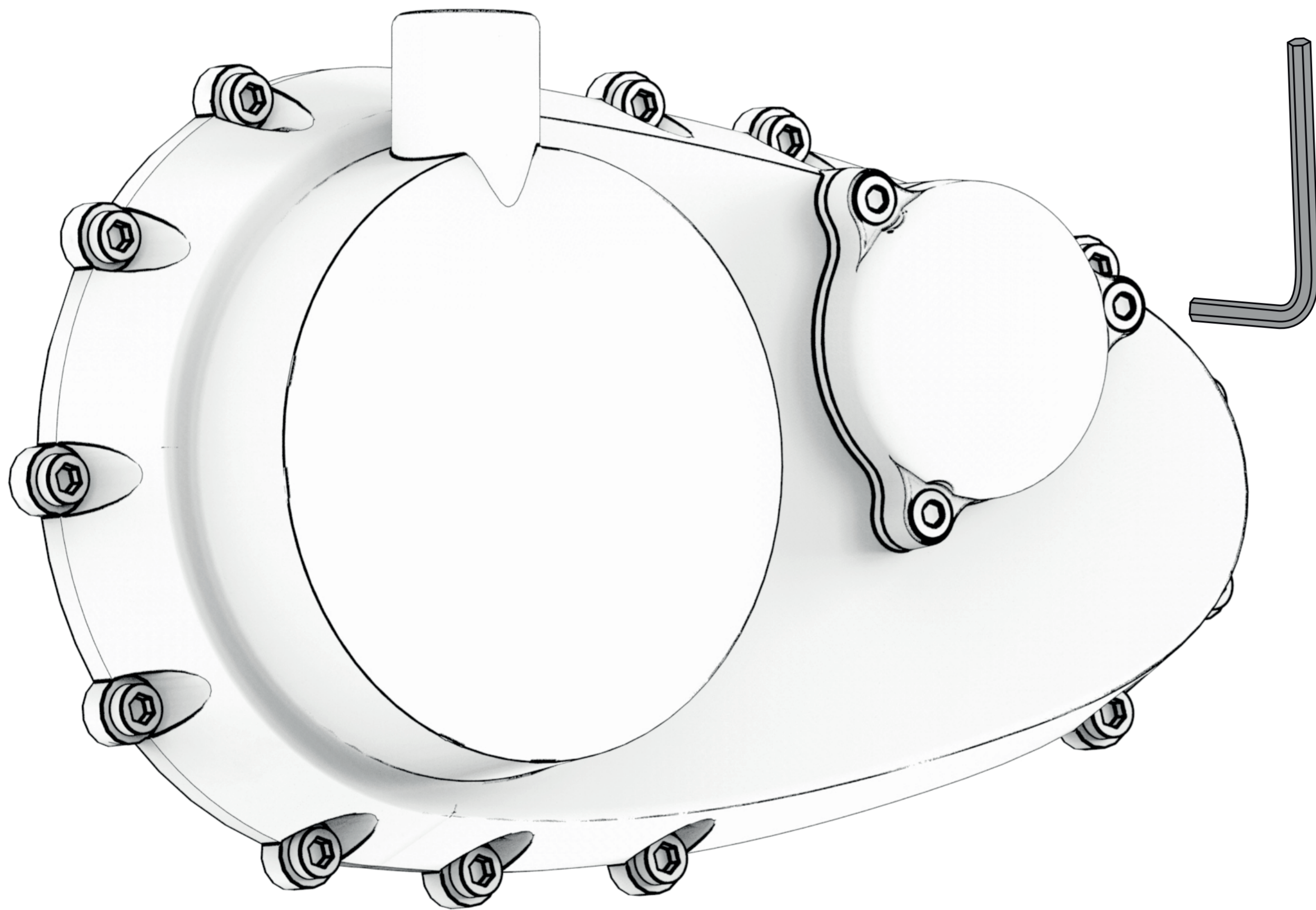

*Cafe
Twin*[®]



STEP . 2

Take out from it the rubber o-ring and place it in the o-ring cavity of your new CafeTwin oil cap.

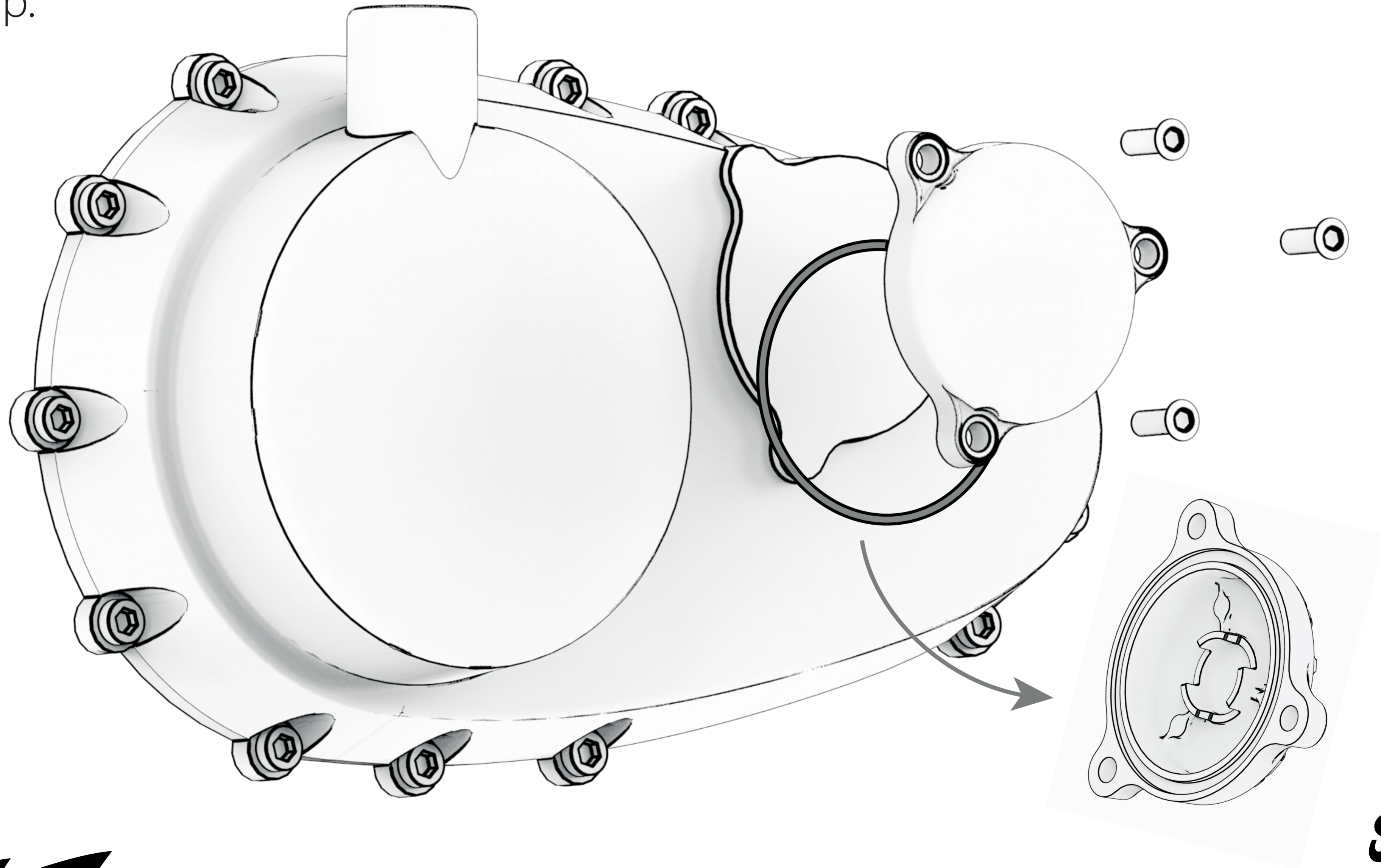

**Cafe
Twin[®]**

STEP . 3

Place the new CafeTwin cap with the original o-ring and screws and use the allen key to screw and tighten them in.

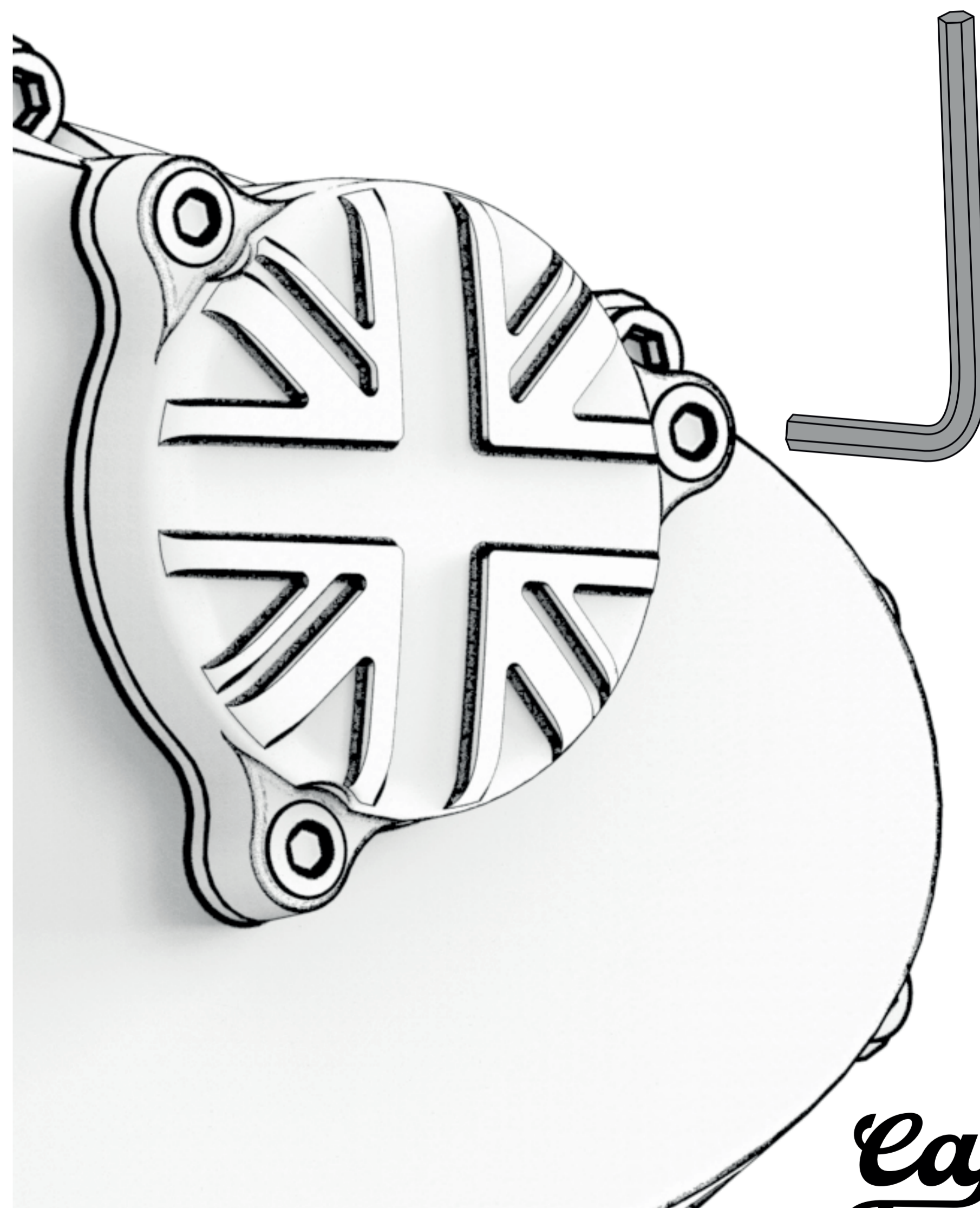
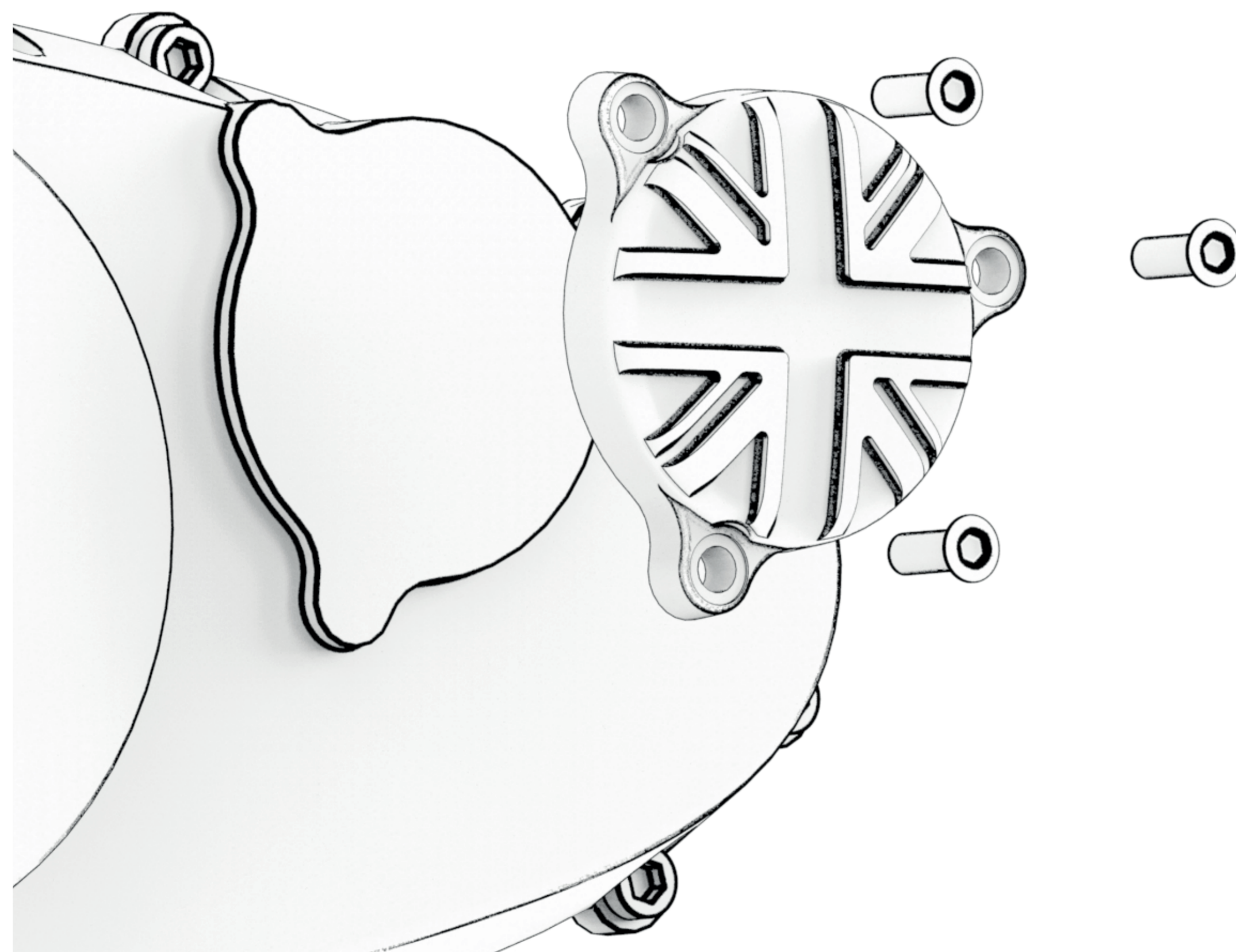

ⓘ We recommend using a torque wrench for perfect tightening.

**Cafe
Twin®**



You dream. We build.

*Cafe
Twin*[®]

