

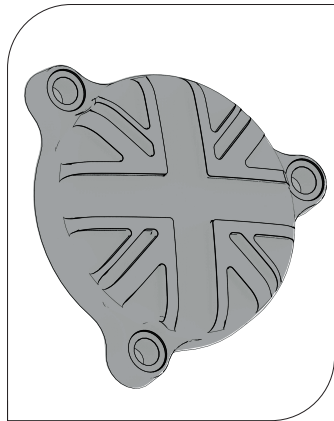

**OIL FILTER CARTER CAP
(ROYAL ENFIELD 350CC)**

Installation Manual

What's in the box



1X
OIL FILTER
CARTER CAP

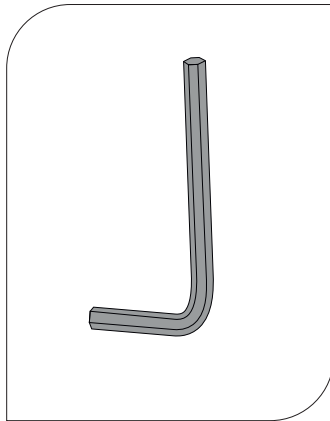

1X
N°5 ALLEN KEY

STEP . 1

Unscrew the original oil cap with the allen key to remove it.

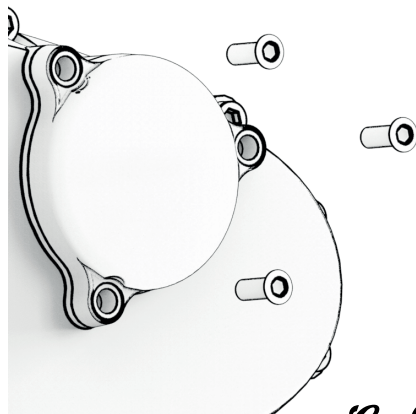
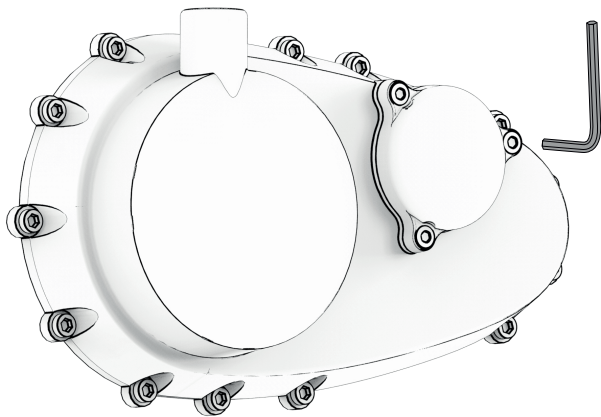

Cafe
Twin®

STEP . 2

Take out from it the rubber o-ring and place it in the o-ring cavity of your new CafeTwin oil cap.

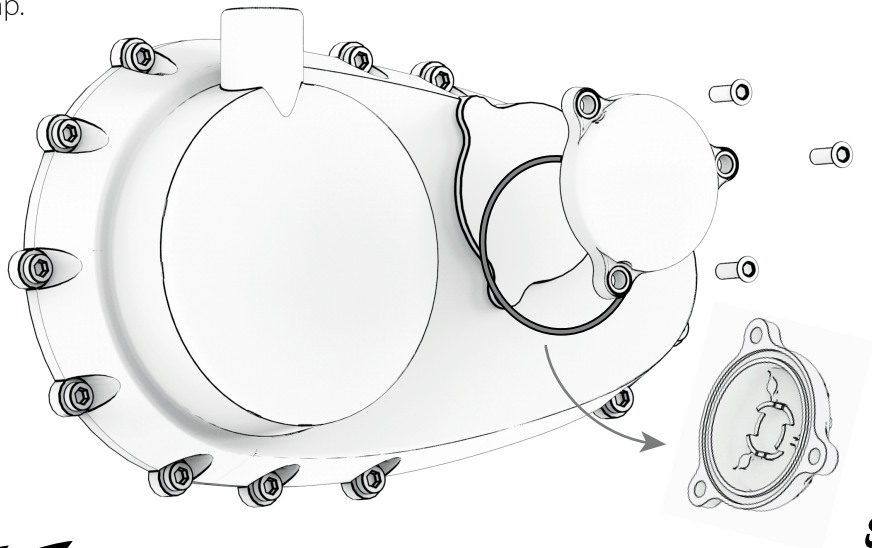

**Cafe
Twin®**

STEP . 3

Place the new CafeTwin cap with the original o-ring and screws and use the allen key to screw and tighten them in.

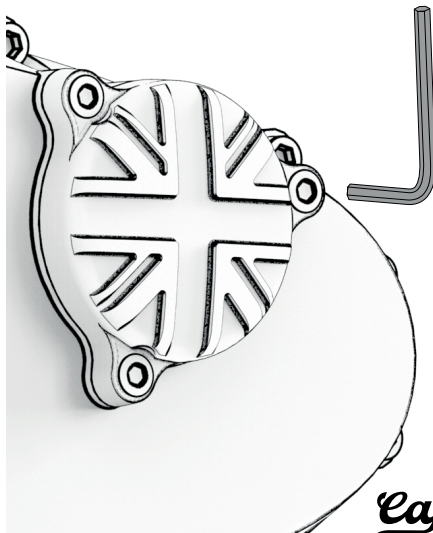
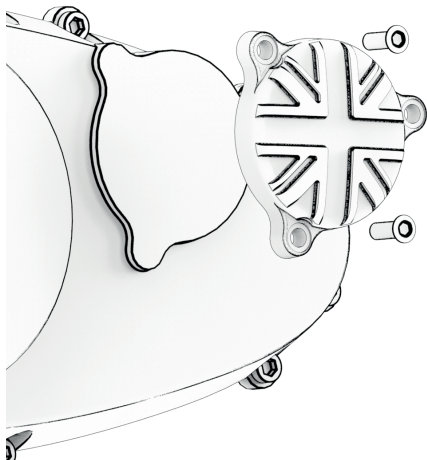

*Cafe
Twin®*

You dream. We build.



Cafe
Twin®