

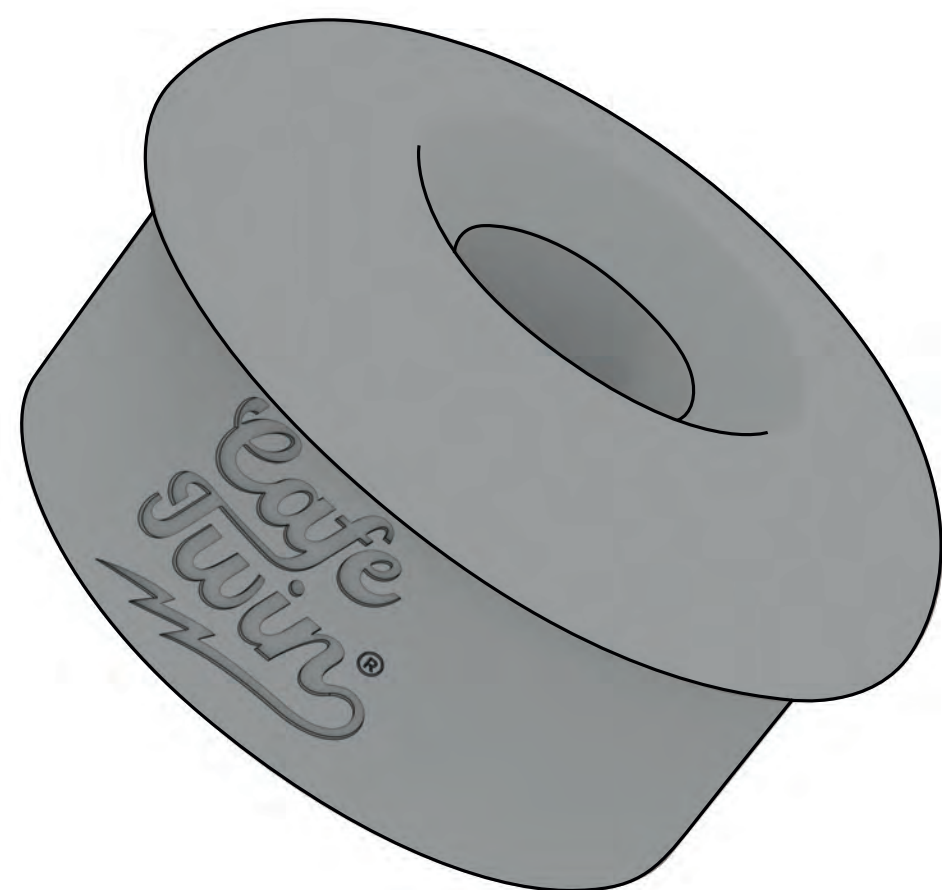

BAR-END MIRROR ADAPTER

Installation Manual

What you need



2x
BAR-END
MIRROR ADAPTER

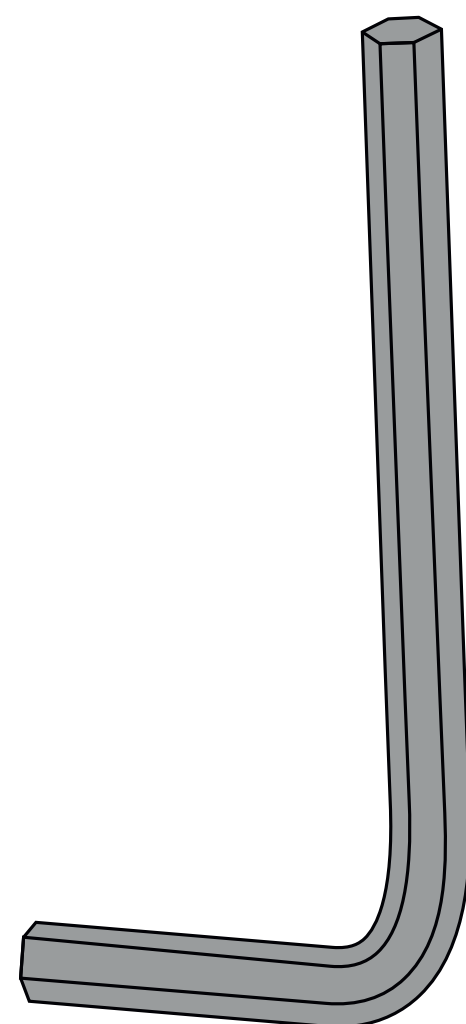

1x
N°6 ALLEN KEY

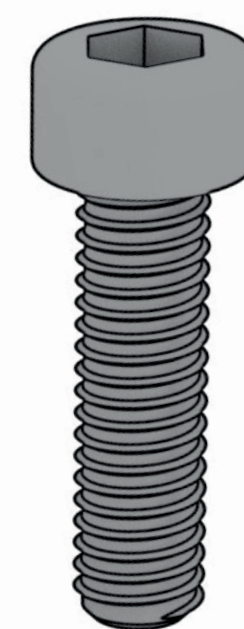

2x
D.6MM X 40MM SCREW
(OR USE THE ORIGINAL ONES)

STEP . 1

After unscrewing the original bar end, insert all the component, including your favourite bar end mirror, as shown in the picture.

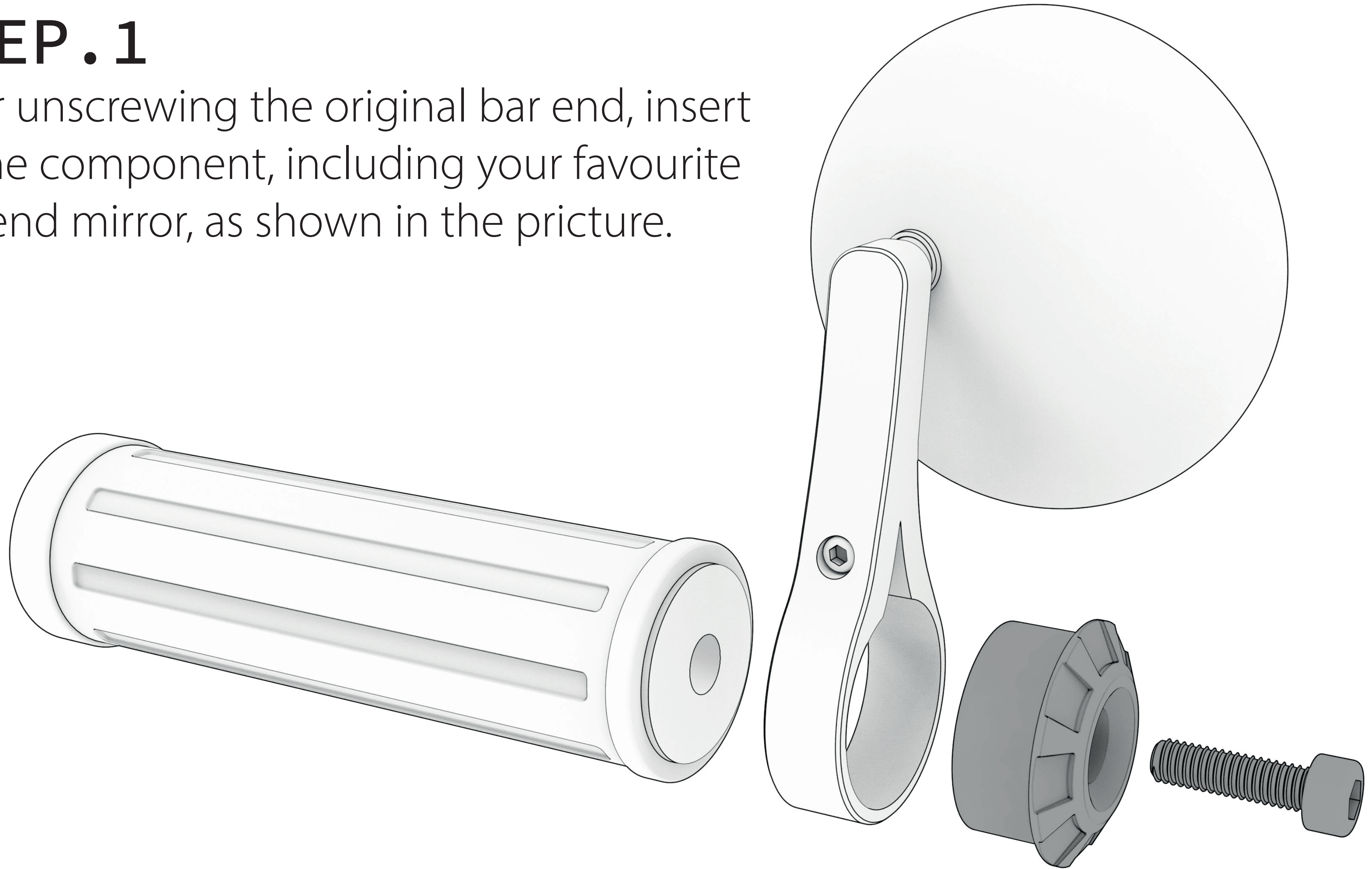

*Cafe
Twin*[®]



STEP . 2

Screw in the screw making sure all the components fit in perfectly.



*Cafe
Twin*[®]



STEP . 3

Tighten the screw with the included allen key (and the mirror as well if the mirror model requires it).



You dream. We build.

*Cafe
Twin*[®]

